



Stonefield Road, Hastings TN34 1QA

Offers in excess of £400,000



An exceptional FOUR BEDROOM, four storey Victorian home set in an enviable position, in the HEART OF THE QUEENS QUARTER which is known for its antique stores, trendy eateries and bars. It's a VIBRANT NEIGHBOURHOOD with an accepting atmosphere and is ideally positioned only a short stroll from Alexandra Park, the beach and Hastings mainline railway station which benefits from connections to London stations. The characterful accommodation here enjoys a versatile layout and is PRESENTED TO AN IMMACULATE STANDARD with new double glazed sash windows and bespoke shutters fitted throughout. The ground floor is arranged as living room with a feature fireplace and bespoke storage with open shelving built in to the alcoves, there is also a bedroom on this floor with stairs rising to the first floor where there are two further bedrooms and a STYLISH BATHROOM with a shower and screen over the bath. The upper floor houses the principal bedroom while the CONTEMPORARY, OPEN PLAN LIVING AREA spans the lower floor with double doors at the rear leading out to the landscaped walled garden. POLISHED CONCRETE FLOORING flows throughout this sociable space which has been designed to entertain, from the kitchen area there is a second entrance to the street and there is also a handy downstairs cloakroom. Situated in a SOUGHT AFTER LOCATION with WEALTH OF PERIOD FEATURES this stunning home is not to be missed.

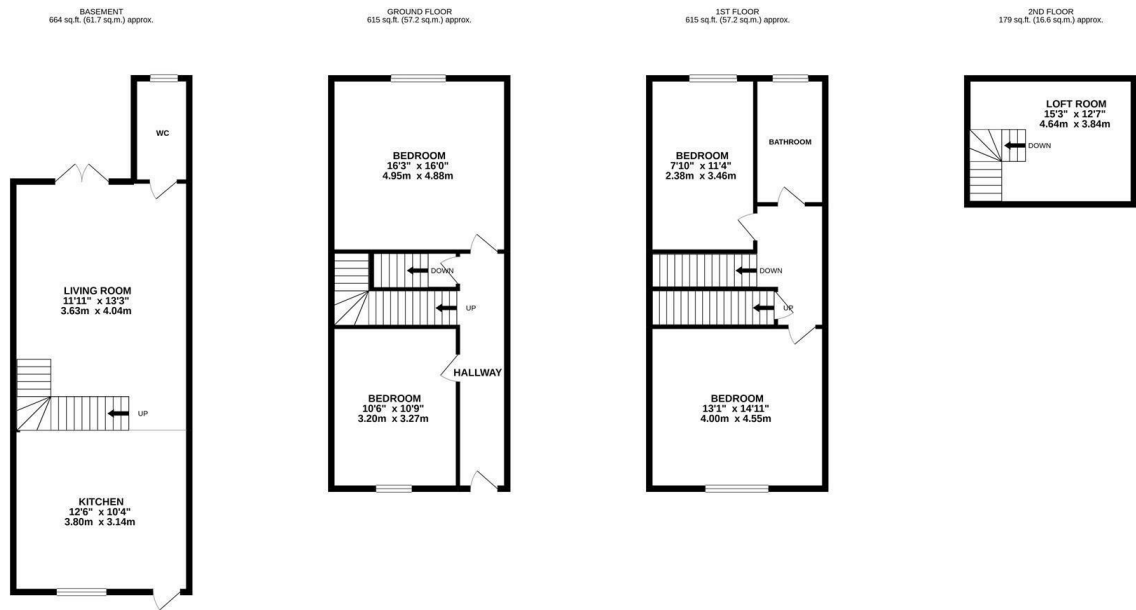

TOTAL FLOOR AREA : 2074 sq.ft. (192.6 sq.m.) approx.

Whilst every attempt has been made to ensure the accuracy of the floorplan contained here, measurements of doors, windows, rooms and any other items are approximate and no responsibility is taken for any error, omission or mis-statement. This plan is for illustrative purposes only and should be used as such by any prospective purchaser. The services, systems and appliances shown have not been tested and no guarantee as to their operability or efficiency can be given.

Made with Metropix ©2021

